

Jungle Fever Tree Quilt

54" x 54"

by Luella Doss & Andrea Schuster



featuring fabric from Jungle Fever collection
by Luella Doss & Andrea Schuster

Free Spirit 

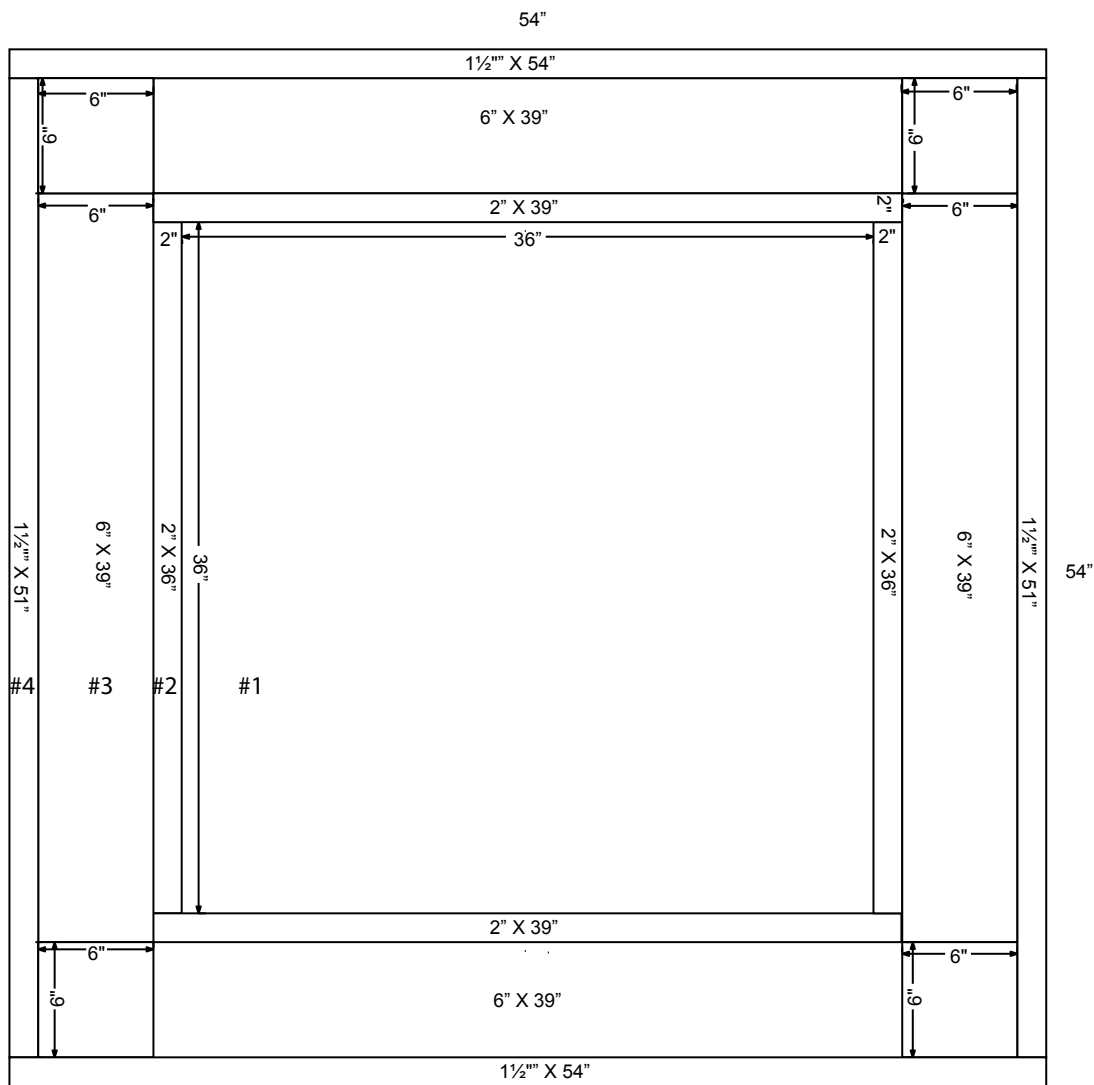

Jungle Fever Tree Quilt

by Luella Doss and Andrea Schuster

- #1. Use Panel from **Jungle Fever Tree of Life LD27** Cut out panel, leaving ¼" seam allowance on all edges. Dimensions should be 36½" x 36½"
- #2. 1st tier of borders from **Swirls LD17 BLUE** Cut (2) strips measuring 2" x 36½" and (2) strips measuring 2" x 39½"
- #3. 2nd tier of borders. Cut (4) strips from **Caladium LD20BLUE** measuring 6½" x 39½", cut (4) 6½" square from **Palm LD16 BLUE**
- #4. 3rd tier of borders. From **Check LD22** Cut (2) strips 2" x 51½" and (2) 2" x 54½"
5. (optional) Applique Birds and orchids. Iron on fusing medium to back of fabric of (2) flying birds and (2) sitting birds and (1) orchid. Cut out and position on to patchwork and iron on.
6. Binding : cut **Swirls LD17 PURPLE** to your favorite width.
7. Use your choice of backing and batting to equal a 60" square.